

# EVOTEC



## EP 1702/1703



INNOVATIVE  
EXTRACTION  
TECHNOLOGY



## EP Dust extractor – 230 Volt



- ★ Very large volume flow
- ★ Accessories can be conveniently transported on the vacuum cleaner
- ★ Filter chamber and container made of V2A stainless steel (1.4301)
- ★ Manual filter cleaning
- ★ Energy-efficient EC motors suitable for continuous operation
- ★ Optional: Extraction arm for optimal extraction directly at the point of origin

# EVOTEK

**EP 1702**  
**EP 1703**

Versions:



**Powerful dust extractor with high air volume for capturing and filtering dry and hazardous to health airborne particles.**

Specially developed for the **reliable extraction and filtration of dry dust** generated during various work processes.

Critical fine dusts are reliably extracted and filtered.

Robust, smooth-running chassis for high mobility. Compact, modular design with high-quality stainless steel dirt container (**V2A**).

Flow rate infinitely variable.

**1st Filter stage:**

**Dust class M** Resistant polyester needle felt pocket filter with **PUR membrane**, high filtering power for long service life.

**2nd Filter stage:**

**Dust class H**  
Absolute cartridge filter (**H13/14**).

Effective, easy-to-use **manual filter cleaning** for high filter power and long working intervals without interruption. Powerful brushless EC motors for continuous operation.

**Vacuum gauge** for filter monitoring.

**Big vacuum inlet** Ø 150 mm with bordure socket.

**Upgrade EX protected** according to ATEX for safe extraction in zone 22.

Length connection cable: 8 m



Model		EP 1702	EP 1703
Voltage	Volt	230	400
Engine power	Watt	2 x 1.100	3 x 1.100
Max. air volume	m³/h	910	1.360
Negative pressure	Pa	10.000	
Filter area „M“	m²	4,1	
Filter area „H“	m²	4,3	
Dirt container	ltr.	50	
Protection class		IP 54	
Noise level	dB(A)	72 dB (A)	
Vacuum connection	Ø mm	150	
Dimensions LxWxH	cm	85 x 80 x 200	
Weight	kg	120	
Dust class M	<b>Item No.</b>	<b>151-3080</b>	<b>151-3082</b>
Dust class H	<b>Item No.</b>	<b>151-3081</b>	<b>151-3083</b>
<b>Upgrade EX-protection</b>	<b>Item No.</b>	<b>054-8042</b>	



# EP Dust extractor – 230 Volt

# EVOTEC

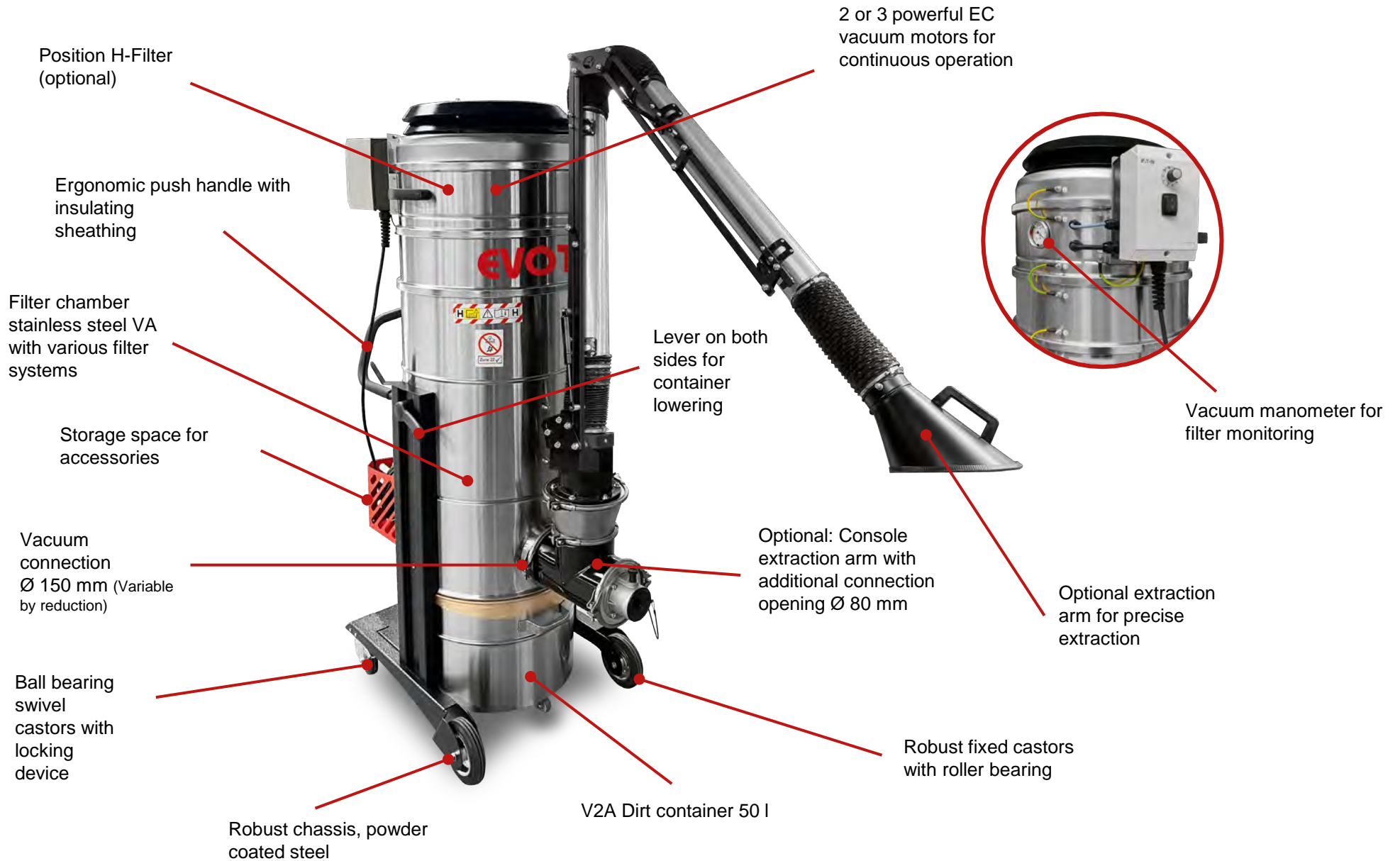





# Accessories and options



Accessories/Filters

Filters and disposal	
	<p><b>Dust class M</b> Polyester needle felt with <b>antistatic PUR membrane</b></p> <p><b>Antistatic</b> - for the extraction of dusts that can become statically charged (<b>installed as standard in EVOTEC units</b>)</p> <p>4,1 m<sup>2</sup>, Ø 500 mm = <b>054-20224</b></p>
	<p><b>Dust class H (H14)</b></p> <p>Absolute cartridge filter Dust class H (H14), support grids on both sides</p> <p>4,3 m<sup>2</sup>, Ø 500 mm = <b>054-20033</b></p>
	<p><b>Plastic waste disposal bags, antistatic ESD</b>  PU = 10 pieces</p> <p>for the dust-free disposal of dust of the dust classes M and H. Extremely stable and "nail-test"-tested. Perfect fit due to round base design - by-pass not necessary!</p> <p><b>Plastic disposal bag black</b>, electrically conductive VE = 10 pieces Suitable for 50 l container = <b>235-1040</b></p>

Device options dust extractor EP1702/1703																	
	<p><b>Vertical extraction arm</b>, incl. extraction bonnet <i>Console to be ordered separately</i></p> <p><b>Aluminium version (as shown)</b></p> <table border="0"> <tr> <td>Ø 125 mm, length 2,0 m</td> <td><b>054-90332</b></td> </tr> <tr> <td>Ø 125 mm, length 3,0 m</td> <td><b>054-90342</b></td> </tr> <tr> <td>Ø 160 mm, length 2,0 m</td> <td><b>054-90333</b></td> </tr> <tr> <td>Ø 160 mm, length 3,0 m</td> <td><b>054-90343</b></td> </tr> </table> <p><b>ATEX version VA</b> </p> <table border="0"> <tr> <td>Ø 125 mm, length 2,0 m</td> <td><b>054-90330</b></td> </tr> <tr> <td>Ø 125 mm, length 3,0 m</td> <td><b>054-90340</b></td> </tr> <tr> <td>Ø 160 mm, length 2,0 m</td> <td><b>054-90331</b></td> </tr> <tr> <td>Ø 160 mm, length 3,0 m</td> <td><b>054-90341</b></td> </tr> </table>	Ø 125 mm, length 2,0 m	<b>054-90332</b>	Ø 125 mm, length 3,0 m	<b>054-90342</b>	Ø 160 mm, length 2,0 m	<b>054-90333</b>	Ø 160 mm, length 3,0 m	<b>054-90343</b>	Ø 125 mm, length 2,0 m	<b>054-90330</b>	Ø 125 mm, length 3,0 m	<b>054-90340</b>	Ø 160 mm, length 2,0 m	<b>054-90331</b>	Ø 160 mm, length 3,0 m	<b>054-90341</b>
Ø 125 mm, length 2,0 m	<b>054-90332</b>																
Ø 125 mm, length 3,0 m	<b>054-90342</b>																
Ø 160 mm, length 2,0 m	<b>054-90333</b>																
Ø 160 mm, length 3,0 m	<b>054-90343</b>																
Ø 125 mm, length 2,0 m	<b>054-90330</b>																
Ø 125 mm, length 3,0 m	<b>054-90340</b>																
Ø 160 mm, length 2,0 m	<b>054-90331</b>																
Ø 160 mm, length 3,0 m	<b>054-90341</b>																
	<p><b>Bracket</b></p> <p>For attaching the extraction arm to the vacuum cleaner. Additional connection opening Ø 80 mm enables hose connection.</p> <p><b>Standard version</b></p> <table border="0"> <tr> <td>Ø 125 mm</td> <td><b>053-3072</b></td> </tr> <tr> <td>Ø 160 mm</td> <td><b>053-3073</b></td> </tr> </table>	Ø 125 mm	<b>053-3072</b>	Ø 160 mm	<b>053-3073</b>												
Ø 125 mm	<b>053-3072</b>																
Ø 160 mm	<b>053-3073</b>																
	<p><b>Hoses</b></p> <p>A variety of hoses and connectors are available in different diameters. We will be happy to advise you personally on the appropriate configuration.</p>																

## Notes

**EVOTEC**

## Notes

**EVOTEC**



MADE IN  
GERMANY

**EVO-PRODUCTS** Blankenburg GmbH – Dieselstraße 3 – 53424 Remagen

Tel.: +49 (0)2642 9373-0 Fax: +49 (0)2642 9373-14

[www.evo-products.de](http://www.evo-products.de) – [info@evo-products.de](mailto:info@evo-products.de)